



BLAULITE HRV EC

Heat recovery ventilators
for commercial applications
featuring advanced EC
(Electronically Commutated)
motor technology

BLAULITE heat recovery ventilators are available in five sizes with one, two or three high-efficiency EC fans in array on both supply and exhaust sides. Units are specially designed for commercial applications.

BLAULITE HRV 5 EC, HRV 8 EC

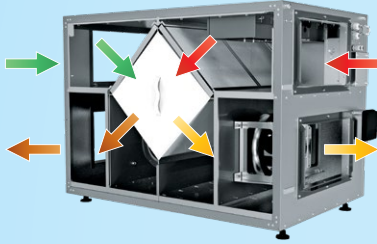

BLAULITE HRV 13 EC, HRV 17 EC

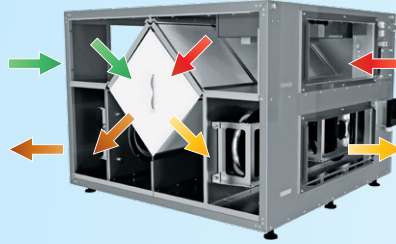

BLAULITE HRV 25 EC

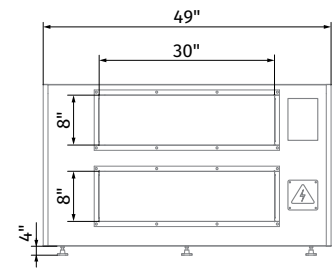
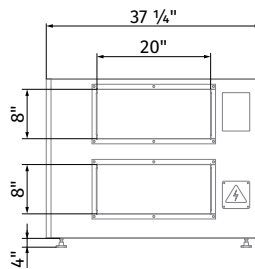
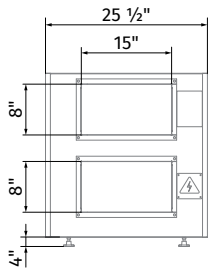
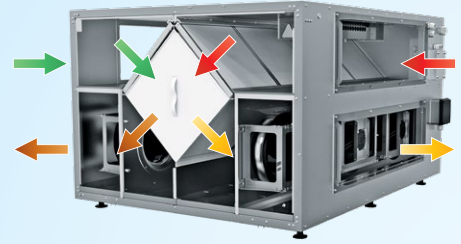

BLAULITE
 HRV 5 EC / HRV 8 EC / HRV 13 EC /
 HRV 17 EC / HRV 25 EC

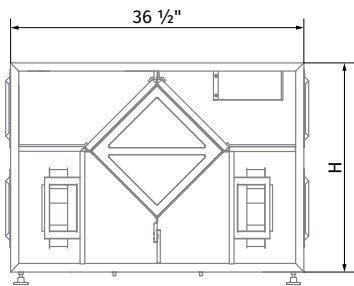

CASING

Steel casing is covered with high quality multilayer aluminium and zinc alloy to prevent corrosion. The casing is equipped with a switch to turn the ventilator off when the service panel is opened. Service access from both left and right side.

FANS

The unit is equipped with supply and exhaust centrifugal fans featuring backward-curved blades and advanced EC (Electronically Commutated) motor technology. These fans deliver superior energy efficiency and precise speed control. They come with built-in thermal over-heating protection and an automatic restart function, ensuring consistent and reliable performance.

Additionally, both the electric motors and impellers are dynamically balanced to minimise noise and vibration, providing smooth and efficient operation.

DEFROST SYSTEM

Fan stop defrost system is activated when the outdoor temperature falls below 23 °F (-5 °C).

Parameters	Blaulite HRV 5 EC	Blaulite HRV 8 EC	Blaulite HRV 13 EC	Blaulite HRV 17 EC	Blaulite HRV 25 EC
Voltage [V / 60 Hz]	1 ~ 208	1 ~ 208	1 ~ 208	1 ~ 208	1 ~ 208
Unit power [W]	330	480	650	940	1385
Unit current [A]	2.4	3.4	4.5	10.5	13.4
Minimum circuit Amps [MCA]	3.0	4.3	5.7	13.2	16.8
Maximum over current protection [MOP]	3.9	5.6	6.0	13.8	16.2
Sensible effectiveness @ max air flow [%]	62	58	61	53	51
Air flow @ ESP 0.4" WG [CFM]	450	610	760	1220	1700
Air flow max [CFM]	520	680	850	1360	1950
Transported air temperature [F]	-35 up to +140	-35 up to +140	-35 up to +140	-35 up to +140	-35 up to +140
Outer skin casing material	21 gauge galvanized steel	21 gauge galvanized steel	21 gauge galvanized steel	21 gauge galvanized steel	21 gauge galvanized steel
Insulation	1" mineral wool	1" mineral wool	1" mineral wool	1" mineral wool	1" mineral wool
Connected air duct size [in]	8x14	8x14	8x20	8x20	8x30
Net [lb]	110	148	179	209	276
Gross [lb]	225	258	313	364	419

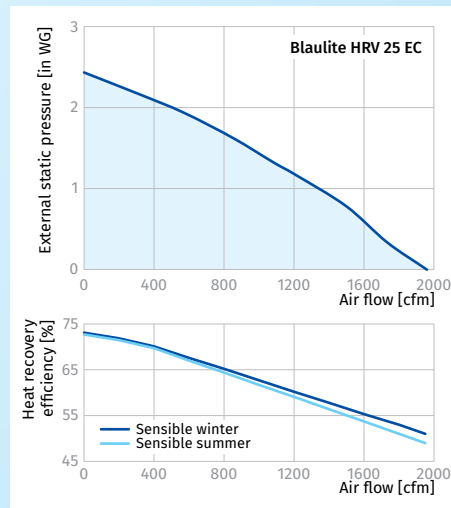
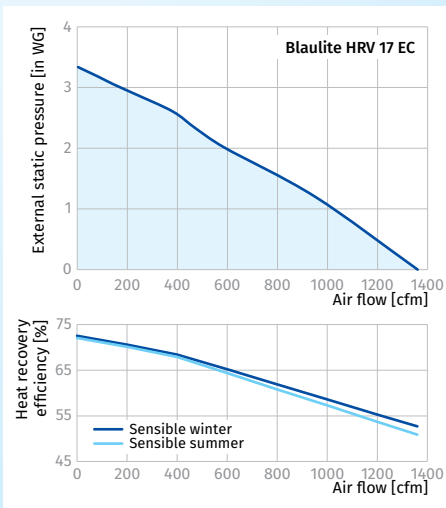
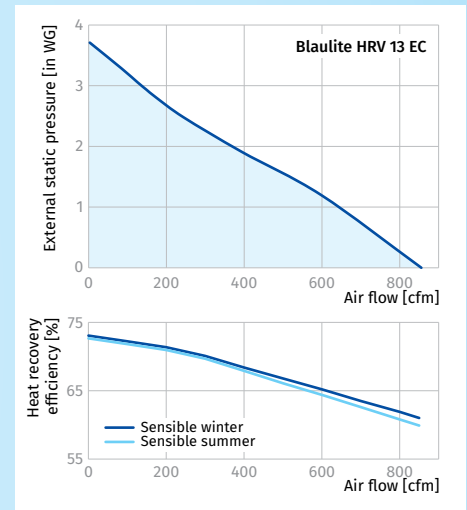
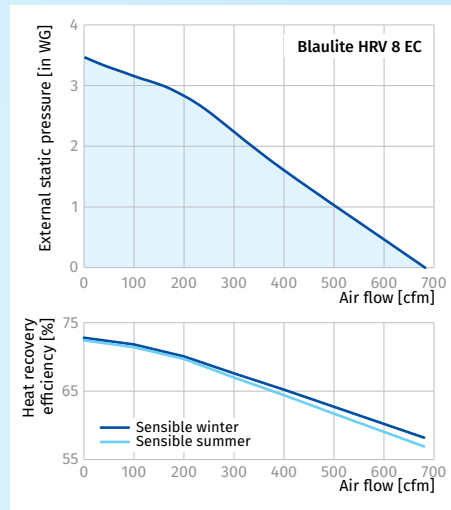
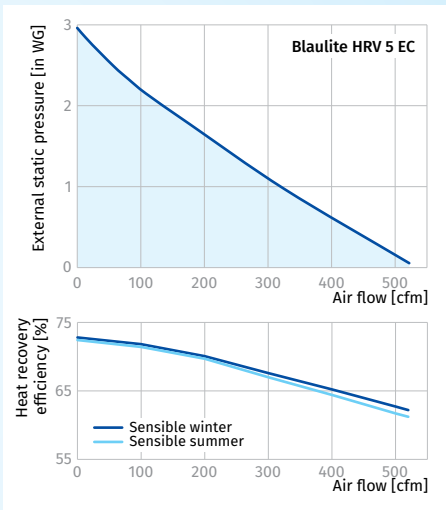

HEAT RECOVERY CORE

Unique plate heat exchanger is made of aluminium and designed for high-efficient heat recovery. The stainless steel drain pan is located on the inlet and outlet sides.

FILTER

Washable MERV 6 air filters in exhaust and supply air streams. Filters MERV 8, MERV 13 optional.

CONTROL

The unit incorporates an integrated automation and control system with following functions:

- Operation mode switch.
- Airflow balancing by supply and exhaust fan independent speed adjustment.
- Automatic recovery core frost protection.
- External control device connection.



Blauberg North America
1501 Veterans Memorial Pkwy E, Ste. 202,
Lafayette, IN 47905
tel.: 765 780 7139

info@blauberg-na.com
blauberg-na.com

Technical changes reserved.
Illustrations and texts are non-binding.