

Centro

Inline centrifugal fans

Use

- Supply and extract ventilation systems installed in various premises.
- Mounting in kitchens, bathrooms and other humid premises.
- Compatible with Ø 4" up to 12" round air ducts.



Air flow:
up to 871 CFM



Power:
from 93 W



Noise level:
from 2.3 Sones



Design

- High quality, UV-resistant plastic case (flame rating – 5VA).
- Aerodynamically shaped casing.
- Airtight mounting box.

Motor

- Single-phase external rotor motor with a centrifugal impeller with backward curved blades.
- Equipped with ball bearings for longer service life.
- Integrated thermal protection with automatic restart.
- Dynamically balanced turbine.

Speed control

- Smooth speed control with an external thyristor controller or step speed control with an external auto transformer.

Mounting

- Due to compact design the fan is the ideal solution for mounting in limited spaces.
- Wall or ceiling mounting with fixing brackets supplied as a standard or with a wire frame **Halter Centro** (available upon separate order).
- Flexible air ducts are fixed on the fan spigots with clamps.



Modifications and options

- FR1:** built-in smooth speed controller from 0 to 100 %. The fan is supplied with a standard electric plug.



- G1:** smooth speed controller with an electronic thermostat and an external temperature sensor that is fixed on 13 ft power cable with a standard electric plug.



- G1:** smooth speed controller with an electronic thermostat and a temperature sensor integrated into the air duct. The fan is supplied with a pre-wired power cable with a standard electric plug.
- GT1:** speed controller, temperature controller with integrated temperature sensor, 5 min timer switch and power cable with mains plug.
- GT1:** speed controller, temperature controller with external temperature sensor (cable length 13 ft), 5 min timer switch and power cable with mains plug.
- GS1:** speed and temperature regulators with an external temperature sensor attached to a 13 ft cable, shutting on when the set temperature is reached. Power cord with a mains plug.

Accessories

Silencers



SD

Filter boxes



KFBK



KFBT

Backdraft air dampers



VRV

Designation key

Series	Duct diameter [mm]	Options
Centro	100; 150; 200; 250; 315	<p>FR1: built-in smooth speed controller adjustable from 0 to 100 %. The fan is supplied with a pre-wired cable with a standard electric plug.</p> <p>G1: smooth speed controller with an electronic thermostat and an external temperature sensor that is fixed on 13 ft cable. The fan is supplied with a pre-wired power cable with a standard plug.</p> <p>G11: smooth speed controller with an electronic thermostat and a temperature sensor integrated into the air duct. The fan is supplied with a pre-wired power cable with a standard electric plug.</p> <p>GT1: speed controller, temperature controller with external temperature sensor, 5 min timer switch and power cable with mains plug.</p> <p>GT11: speed controller, temperature controller with integrated temperature sensor, 5 min timer switch and power cable with mains plug.</p> <p>GS1: speed controller with an electronic thermostat and a temperature sensor fixed on a 13 ft cable. Temperature-based switching on.</p>

Dimensions [in]

Model	Duct dia	Ø D	Ø D1	B	L	L1	L2	L3	Weight [lb]
Centro 100	4"	3 15/16"	9 13/16"	10 5/8"	9 1/16"	1 3/16"	1 1/16"	1 3/16"	4.7
Centro 150	6"	5 7/8"	11 13/16"	12 3/16"	11 1/4"	1 3/16"	1 3/16"	1 3/16"	5.7
Centro 200	8"	7 7/8"	13 3/8"	13 15/16"	10 7/8"	1 3/16"	1 3/16"	1 9/16"	8.8
Centro 250	10"	9 13/16"	13 3/8"	13 15/16"	10 7/16"	1 3/16"	1 3/16"	1 9/16"	9.9
Centro 315	12"	12 3/8"	15 3/4"	16 5/16"	16 5/16"	1 9/16"	2 3/16"	1 9/16"	11.2

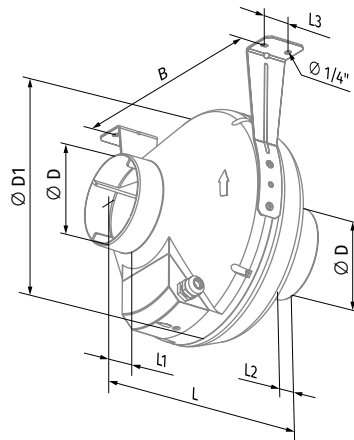

Technical data

Model	Duct dia	Sones	RPM*	Watts*	Amps*	CFM*	CFM vs. Static Pressure (Ps) in WG										Max Ps, in WG	Volts	
							0	0.1	0.2	0.3	0.4	0.5	0.6	0.7	0.8	0.9			1
Centro 100	4"	2.3	2980	109	0.94	170**	183	175	170**	164	154**	147	138**	130	122	115	106	2.2	120
Centro 150	6"	2.7	2785	93	0.77	290**	321	307	290**	272	255**	237	222**	206	193	175	159	1.8	120
Centro 200	8"	3.5	2781	149	1.25	520**	562	536	520**	501	472**	451	424**	397	372	347	329	2.5	120
Centro 250	10"	4.3	2523	266	2.25	620**	683	653	620**	588	551**	518	487**	453	423	394	368	3.1	120
Centro 315	12"	4.1	2641	269	2.25	770**	871	825	770**	736	683**	645	569**	515	476	430	388**	2.8	120

* The parameters RPM, Watts, Amps are indicated at 0.2 in WG static pressure.

** HVI rated.