

# CENTRO 100

## Inline centrifugal fans



### Description

- o Centro inline fans assure efficient and reliable operation.
- o The Centro fans are specially designed for simple installation and years of maintenance free operation.
- o The Centro fans are supplied with an easy to fit mounting bracket and can be mounted at any angle and at any point along the duct.
- o Five year warranty.



### Casing

- o The fans' casing is made of high quality, UV-resistant plastic (UL94 certified plastic).

### Motor

- o The fan is fitted with backward curved centrifugal impeller driven by powerful sealed external rotor motor with lifelong bearings and thermal protection.

### Suitable for:

- o The fans are suitable for a wide range of residential and commercial exhaust or supply air applications, such as bathrooms, kitchens, restaurants or equipment cooling.

### Dimensions [in]

Model	Duct dia	Ø D	Ø D1	B	L	L1	L2	L3	Weight [lb]
Centro 100	4"	3 15/16"	9 13/16"	10 5/8"	9 1/16"	1 3/16"	1 1/16"	1 3/16"	4.7

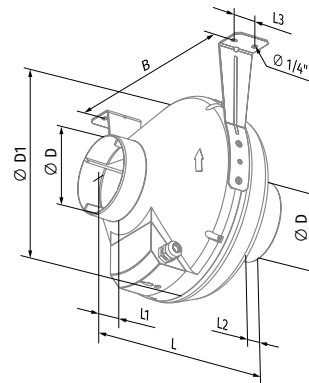

### Technical data

Model	Duct dia	Sones	RPM*	Watts*	Amps*	CFM*	CFM vs. Static Pressure (Ps) in WG										Max Ps, in WG	Volts	
							0	0.1	0.2	0.3	0.4	0.5	0.6	0.7	0.8	0.9			1
Centro 100	4"	2.3	2980	109	0.94	170**	183	175	170**	164	154**	147	138**	130	122	115	106	2.2	120

\* The parameters RPM, Watts, Amps are indicated at 0.2 in WG static pressure.  
\*\* HVI rated.

MODEL	QUANTITY	COMMENTS	PROJECT
			location:
			architect:
			engineer:
			contractor:
			submitted by:

# CENTRO 150

## Inline centrifugal fans



### Description

- o Centro inline fans assure efficient and reliable operation.
- o The Centro fans are specially designed for simple installation and years of maintenance free operation.
- o The Centro fans are supplied with an easy to fit mounting bracket and can be mounted at any angle and at any point along the duct.
- o Five year warranty.



### Casing

- o The fans' casing is made of high quality, UV-resistant plastic (UL94 certified plastic).

### Motor

- o The fan is fitted with backward curved centrifugal impeller driven by powerful sealed external rotor motor with lifelong bearings and thermal protection.

### Suitable for:

- o The fans are suitable for a wide range of residential and commercial exhaust or supply air applications, such as bathrooms, kitchens, restaurants or equipment cooling.

### Dimensions [in]

Model	Duct dia	Ø D	Ø D1	B	L	L1	L2	L3	Weight [lb]
Centro 150	6"	5 7/8"	11 13/16"	12 3/16"	11 1/4"	1 3/16"	1 3/16"	1 3/16"	5.7

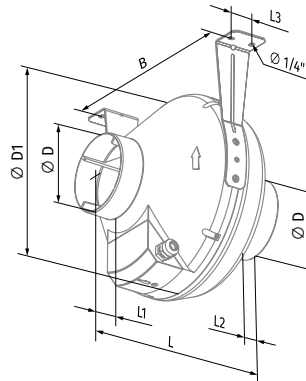

### Technical data

Model	Duct dia	Sones	RPM*	Watts*	Amps*	CFM*	CFM vs. Static Pressure (Ps) in WG											Max Ps, in WG	Volts
							0	0.1	0.2	0.3	0.4	0.5	0.6	0.7	0.8	0.9	1		
Centro 150	6"	2.7	2785	93	0.77	290**	321	307	290**	272	255**	237	222**	206	193	175	159	1.8	120

\* The parameters RPM, Watts, Amps are indicated at 0.2 in WG static pressure.  
\*\* HVI rated.

MODEL	QUANTITY	COMMENTS	PROJECT
			location:
			architect:
			engineer:
			contractor:
			submitted by:

# CENTRO 200

## Inline centrifugal fans



### Description

- o Centro inline fans assure efficient and reliable operation.
- o The Centro fans are specially designed for simple installation and years of maintenance free operation.
- o The Centro fans are supplied with an easy to fit mounting bracket and can be mounted at any angle and at any point along the duct.
- o Five year warranty.



### Casing

- o The fans' casing is made of high quality, UV-resistant plastic (UL94 certified plastic).

### Motor

- o The fan is fitted with backward curved centrifugal impeller driven by powerful sealed external rotor motor with lifelong bearings and thermal protection.

### Suitable for:

- o The fans are suitable for a wide range of residential and commercial exhaust or supply air applications, such as bathrooms, kitchens, restaurants or equipment cooling.

### Dimensions [in]

Model	Duct dia	Ø D	Ø D1	B	L	L1	L2	L3	Weight [lb]
Centro 200	8"	7 7/8"	13 3/8"	13 15/16"	10 7/8"	1 3/16"	1 3/16"	1 9/16"	8.8

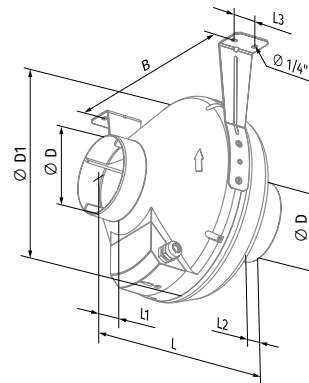

### Technical data

Model	Duct dia	Sones	RPM*	Watts*	Amps*	CFM*	CFM vs. Static Pressure (Ps) in WG											Max Ps, in WG	Volts
							0	0.1	0.2	0.3	0.4	0.5	0.6	0.7	0.8	0.9	1		
Centro 200	8"	3.5	2781	149	1.25	520**	562	536	520**	501	472**	451	424**	397	372	347	329	2.5	120

\* The parameters RPM, Watts, Amps are indicated at 0.2 in WG static pressure.  
\*\* HVI rated.

MODEL	QUANTITY	COMMENTS	PROJECT
			location:
			architect:
			engineer:
			contractor:
			submitted by:

# CENTRO 250

## Inline centrifugal fans



### Description

- o Centro inline fans assure efficient and reliable operation.
- o The Centro fans are specially designed for simple installation and years of maintenance free operation.
- o The Centro fans are supplied with an easy to fit mounting bracket and can be mounted at any angle and at any point along the duct.
- o Five year warranty.



### Casing

- o The fans' casing is made of high quality, UV-resistant plastic (UL94 certified plastic).

### Motor

- o The fan is fitted with backward curved centrifugal impeller driven by powerful sealed external rotor motor with lifelong bearings and thermal protection.

### Suitable for:

- o The fans are suitable for a wide range of residential and commercial exhaust or supply air applications, such as bathrooms, kitchens, restaurants or equipment cooling.

### Dimensions [in]

Model	Duct dia	Ø D	Ø D1	B	L	L1	L2	L3	Weight [lb]
Centro 250	10"	9 13/16"	13 3/8"	13 15/16"	10 7/16"	1 3/16"	1 3/16"	1 9/16"	9.9

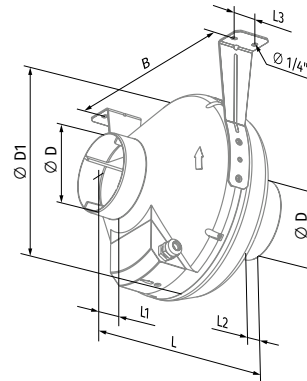

### Technical data

Model	Duct dia	Sones	RPM*	Watts*	Amps*	CFM*	CFM vs. Static Pressure (Ps) in WG											Max Ps, in WG	Volts
							0	0.1	0.2	0.3	0.4	0.5	0.6	0.7	0.8	0.9	1		
Centro 250	10"	4.3	2523	266	2.25	620**	683	653	620**	588	551**	518	487**	453	423	394	368	3.1	120

\* The parameters RPM, Watts, Amps are indicated at 0.2 in WG static pressure.  
\*\* HVI rated.

MODEL	QUANTITY	COMMENTS	PROJECT
			location:
			architect:
			engineer:
			contractor:
			submitted by:

# CENTRO 315

## Inline centrifugal fans



### Description

- Centro inline fans assure efficient and reliable operation.
- The Centro fans are specially designed for simple installation and years of maintenance free operation.
- The Centro fans are supplied with an easy to fit mounting bracket and can be mounted at any angle and at any point along the duct.
- Five year warranty.



### Casing

- The fans' casing is made of high quality, UV-resistant plastic (UL94 certified plastic).

### Motor

- The fan is fitted with backward curved centrifugal impeller driven by powerful sealed external rotor motor with lifelong bearings and thermal protection.

### Suitable for:

- The fans are suitable for a wide range of residential and commercial exhaust or supply air applications, such as bathrooms, kitchens, restaurants or equipment cooling.

### Dimensions [in]

Model	Duct dia	Ø D	Ø D1	B	L	L1	L2	L3	Weight [lb]
Centro 315	12"	12 3/8"	15 3/4"	16 5/16"	16 5/16"	1 9/16"	2 3/16"	1 9/16"	11.2

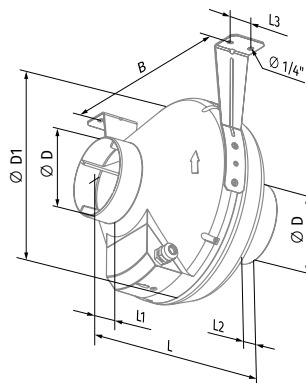

### Technical data

Model	Duct dia	Sones	RPM*	Watts*	Amps*	CFM*	CFM vs. Static Pressure (Ps) in WG											Max Ps, in WG	Volts
							0	0.1	0.2	0.3	0.4	0.5	0.6	0.7	0.8	0.9	1		
Centro 315	12"	4.1	2641	269	2.25	770**	871	825	770**	736	683**	645	569**	515	476	430	388**	2.8	120

\* The parameters RPM, Watts, Amps are indicated at 0.2 in WG static pressure.  
\*\* HVI rated.

MODEL	QUANTITY	COMMENTS	PROJECT
			location:
			architect:
			engineer:
			contractor:
			submitted by: