

CENTRO 125

Inline centrifugal fans



Description

- o Centro inline fans assure efficient and reliable operation.
- o The Centro fans are specially designed for simple installation and years of maintenance free operation.
- o The Centro fans are supplied with an easy to fit mounting bracket and can be mounted at any angle and at any point along the duct.
- o Five year warranty.



Casing

- o The fans' casing is made of high quality, UV-resistant plastic (UL94 certified plastic).

Motor

- o The fan is fitted with backward curved centrifugal impeller driven by powerful sealed external rotor motor with lifelong bearings and thermal protection.

Suitable for:

- o The fans are suitable for a wide range of residential and commercial exhaust or supply air applications, such as bathrooms, kitchens, restaurants or equipment cooling.

Dimensions [in]

Model	Duct dia	Ø D	Ø D1	B	L	L1	L2	L3	Weight [lb]
Centro 125	5"	4 15/16"	9 13/16"	10 5/8"	8 11/16"	1 3/16"	1 1/16"	1 3/16"	4.9

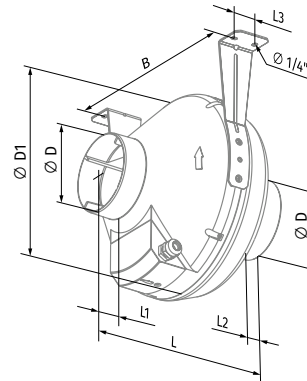

Technical data

Model	Duct dia	Sones	RPM*	Watts*	Amps*	CFM*	CFM vs. Static Pressure (Ps) in WG											Max Ps, in WG	Volts
							0	0.1	0.2	0.3	0.4	0.5	0.6	0.7	0.8	0.9	1		
Centro 125	5"	2.3	2960	114	0.95	214	235	220	214	198	185	178	167	156	145	134	123	2.4	120

* The parameters RPM, Watts, Amps are indicated at 0.2 in WG static pressure.
** HVI rated.

MODEL	QUANTITY	COMMENTS	PROJECT
			location:
			architect:
			engineer:
			contractor:
			submitted by: